

ECAN
JIANGXI YIKAI ELECTRIC CO., LTD.

接头系列

Tube connector series



精品接头
经典升级
High-end Pneumatic Fittings



直立接头 Fitting

PC 系列
直立接头(外牙)
PC Series
Screw thread straight union

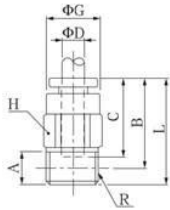

规格 Specification										
管径 Bore ϕD	牙径 Port R	型式 Model	A	B	C	ϕG	L	对边 Subtense H	有效断面积 Valid acreage mm^2	重量 Weight (g)
$\phi 4$	M5	PC4-M5	3.6	15.6	14.2	10	19.2	10	4	5
	1/8"	PC4-01	6	16.4	14.2	10	19.4	10	5.5	6
	1/4"	PC4-02	9	14.2	14.2	10	18.7	14	5.5	13
$\phi 6$	M5	PC6-M5	3.6	18.3	16.3	12	21.9	12	4	8
	1/8"	PC6-01	6	18.5	17	12	21.5	12	12.5	7.5
	1/4"	PC6-02	9	19.1	17	12	23.6	14	12.5	15
$\phi 8$	3/8"	PC6-03	9	16.9	17	12	21.4	17	12.5	23
	1/8"	PC8-01	6	23.7	18.7	14	26.7	14	20	12.5
	1/4"	PC8-02	6	23	18.7	14	26	14	20	15
$\phi 10$	3/8"	PC8-03	9	17.1	18.7	14	21.6	17	20	19
	1/8"	PC10-01	6	24.5	19.4	17	27.5	17	22	21
	1/4"	PC10-02	9	25	19.4	17	29.5	17	35	23
$\phi 12$	3/8"	PC10-03	9	22.5	19.4	17	27	17	35	25
	1/2"	PC10-04	11	21.5	19.4	17	27	21	35	40
	3/8"	PC12-03	9	25.7	22.4	20	30.2	21	58	27
	1/2"	PC12-04	11	25.2	22.4	20	30.7	21	58	39

PCF 系列
直立接头(内牙)
PCF Series
Female connector

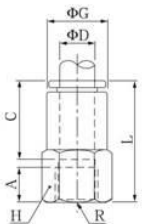

规格 Specification										
管径 Bore ϕD	牙径 Port R	型式 Model	A	C	ϕG	L	对边 Subtense H	有效断面积 Valid acreage mm^2	重量 Weight (g)	
$\phi 4$	1/8"	PCF4-01	8	14.3	10	24.5	10	4		
	1/4"	PCF4-02	11	14.3	10	27.5	10	5.5	20.5	
$\phi 6$	1/8"	PCF6-01	8	16.7	12	26.7	12	12.5	12	
	1/4"	PCF6-02	11	16.7	12	29.1	14	12.5	21	
$\phi 8$	1/8"	PCF8-01	8	18.2	14.3	28	14	20	18	
	1/4"	PCF8-02	11	18.2	14.3	31	14	20	25	
	3/8"	PCF8-03	12	18.2	14.3	32	14	20		
$\phi 10$	1/4"	PCF10-02	11	19.4	17	34	17	22		
	3/8"	PCF10-03	12	19.4	17	35	17	35		
$\phi 12$	1/4"	PCF12-02	11	22.4	20	36	21	58		
	3/8"	PCF12-03	12	22.4	20	36	21	58		

L 型接头, 加长 L 型接头

Fitting

6

接头系列

Tube connector series

PL 系列
直立接头(外牙)
PL Series
Male elbow connector

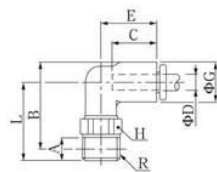

规格 Specification

管径 Bore φ D	牙径 Port R	型式 Model	A	B	C	E	φ G	L	对边 Subtense H	有效断面积 Valid acreage mm ²	重量 Weight (g)
φ 4	M5	PL4-M5	3.6	19.8	14.4	17.3	10.5	16.4	10	3.5	6
	1/8"	PL4-01	6	22.4	14.4	17.3	10.5	20.2	10	4.2	10
	1/4"	PL4-02	9	24.1	14.4	17.3	10.5	23.4	14	4.2	16
φ 6	M5	PL6-M5	3.6	22.5	17	20.6	12.4	18.9	10	3.5	8.5
	1/8"	PL6-01	6	25.9	17	20.6	12.4	22.7	10	10	10.5
	1/4"	PL6-02	9	27.7	17	20.6	12.4	26	14	10	18
	3/8"	PL6-03	9	28.4	17	20.6	12.4	26.7	17	10	22.5
φ 8	1/8"	PL8-01	6	27.6	18.8	23	14.3	23.4	12	16	13.5
	1/4"	PL8-02	9	29.4	18.8	23	14.3	26.7	14	16	19
	3/8"	PL8-03	9	30.1	18.8	23	14.3	27.4	17	16	24.5
φ 10	1/8"	PL10-01	6	31.6	19.7	26.8	17.8	27.5	17	16	27
	1/4"	PL10-02	9	33.4	19.7	26.8	17.8	29	17	30	29
	3/8"	PL10-03	9	34.1	19.7	26.8	17.8	29.7	17	30	31
	1/2"	PL10-04	11	36.1	19.7	26.8	17.8	32.7	21	30	46
φ 12	3/8"	PL12-03	9	36.9	22.3	29.6	20.8	31	21	50	36
	1/2"	PL12-04	11	38.9	22.3	29.6	20.8	34	21	50	50

PLL 系列
加长 L 型接头
PLL Series
Extended male elbow

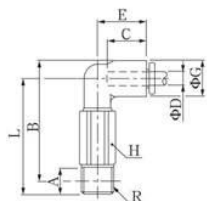

规格 Specification

管径 Bore φ D	牙径 Port R	型式 Model	A	B	C	E	φ G	L	对边 Subtense H	有效断面积 Valid acreage mm ²	重量 Weight (g)
φ 4	1/8"	PLL4-01	6	35.4	14.4	17.3	10.5	33.2	10	4.2	
	1/4"	PLL4-02	9	37.1	14.4	17.3	10.5	36.4	14	4.2	
φ 6	1/8"	PLL6-01	6	38.9	17	20.6	12.4	35.7	10	10	20
	1/4"	PLL6-02	9	40.7	17	20.6	12.4	40	14	10	
φ 8	1/8"	PLL8-01	6	42.6	18.8	23	14.3	38.4	12	16	42.5
	1/4"	PLL8-02	9	44.4	18.8	23	14.3	41.7	14	16	43.5
	3/8"	PLL8-03	9	45.1	18.8	23	14.3	42.4	17	16	54
φ 10	1/4"	PLL10-02	9	53.4	19.7	26.8	17.8	49	17	30	
	3/8"	PLL10-03	9	54.1	19.7	26.8	17.8	49.7	17	30	
	1/2"	PLL10-04	11	56.1	19.7	26.8	17.8	52.7	21	30	
φ 12	3/8"	PLL12-03	9	58.9	22.3	29.6	20.8	53	21	50	
	1/2"	PLL12-04	11	60.9	22.3	29.6	20.8	56	21	50	

螺牙接管, 弯头内螺纹接头

Fitting

PM 系列
螺牙接管
PM Series
Bulkhead union connector

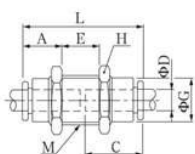

PLF 系列 - 弯头内螺纹
PLF Series female
elbow

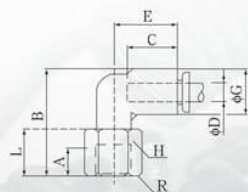

规格 Specification

管径 Bore φ D	牙径 Port R	型式 Model	A	C	E	φ G	L	对边 Subtense H	有效断面积 Valid acreage mm ²	重量 Weight (g)
φ 4	M12 × 1	PM4-4	9.5	14.5	7	10	31.5	14	4.2	16
φ 6	M14 × 1	PM6-6	10	16.9	10	12	35.5	17	10	20
φ 8	M16 × 1	PM8-8	12	18.8	10	14	38	19	16	32
φ 10	M20 × 1	PM10-10	12	19.6	13	18	43	24	30	
φ 12	M22 × 1	PM12-12	12	22.3	18	20	48	27	50	

规格 Specification

管径 Bore φ D	牙径 Port R	型式 Model	A	B	C	E	φ G	L	对边 Subtense H
φ 4	M5	PLF4-M5	6	22.3	14.4	17.3	10.5	8	10
	1/8"	PLF4-01	8	24.3	14.4	17.3	10.5	10	12
	1/4"	PLF4-02	11	27.3	14.4	17.3	10.5	13	17
φ 6	M5	PLF6-M5	6	25.3	17.0	20.6	12.4	8	10
	1/8"	PLF6-01	8	27.5	17.0	20.6	12.4	10	12
	1/4"	PLF6-02	11	30.5	17.0	20.6	12.4	13	17
	3/8"	PLF6-03	12	32.0	17.0	20.6	12.4	14.5	19
φ 8	1/8"	PLF8-01	8	29.4	18.8	23.0	14.3	10	12
	1/4"	PLF8-02	11	32.4	18.8	23.0	14.3	13	17
	3/8"	PLF8-03	12	33.9	18.8	23.0	14.3	14.5	19
φ 10	1/8"	PLF10-01	8	34.0	19.7	26.8	17.8	10	15
	1/4"	PLF10-02	11	36.0	19.7	26.8	17.8	13	17
	3/8"	PLF10-03	12	37.5	19.7	26.8	17.8	14.5	19
	1/2"	PLF10-04	12	37.5	19.7	26.8	17.8	14.5	24
φ 12	3/8"	PLF12-03	12	42.5	22.3	29.6	20.8	14.5	19
	1/2"	PLF12-04	12	42.5	22.3	29.6	20.8	14.5	24

串联接头, T 型二通接头 Fitting

6

接头系列 Tube connector series

PHF 系列 – 串联接头 PHF Series female banjo

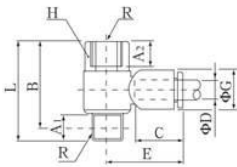

规格 Specification

管径 Bore φ D	牙径 Port R	型式 Model	A1	A2	B	C	E	φ G	L	对边 Subtense H
φ 4	M5	PHF4-M5	4	5	18.5	15	21.5	10.5	21	8
	1/8"	PHF4-01	7.5	8	25	19	25.5		28	12
φ 6	M5	PHF6-M5	4	5	18.5	15	21.5	12.4	21	8
	1/8"	PHF6-01	7.5	8	25	19	25.5		28	12
	1/4"	PHF6-02	10	11	33	21	29		37	17
φ 8	1/4"	PHF8-02	10	11	33	21	29	14.3	37	17
	3/8"	PHF8-03	11	12	33.5	24	34		38	19
φ 10	1/4"	PHF10-02	10	11	33	21	29	18	37	17
	3/8"	PHF10-03	11	12	33.5	24	34		38	19
φ 12	3/8"	PHF12-03	11	12	33.5	24	34	21.5	38	19
	1/2"	PHF12-04	12	15	38.5	25	37		43	24

PB 系列 T 型二通接头 PB Series T male branch tee connector

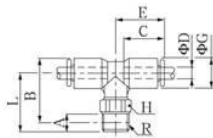

规格 Specification

管径 Bore φ D	牙径 Port R	型式 Model	A	B	C	E	φ G	L	对边 Subtense H	有效断面积 Valid acreage mm ²	重量 Weight (g)
φ 4	M5	PB4-M5	3.6	19.8	14.6	17.5	10.5	16.4	10	3.5	8
	1/8"	PB4-01	6	22.4	14.6	17.5	10.5	20.2	10	4.2	12
	1/4"	PB4-02	9	24.1	14.6	17.5	10.5	23.4	14	4.2	18
φ 6	M5	PB6-M5	3.6	23.3	16.9	20.5	12.4	18.9	10	3.5	11.5
	1/8"	PB6-01	6	25.9	16.9	20.5	12.4	22.7	10	10	13.5
	1/4"	PB6-02	9	27.7	16.9	20.5	12.4	26	14	10	20.5
	3/8"	PB6-03	9	28.4	16.9	20.5	12.4	26.7	17	10	25.5
φ 8	1/8"	PB8-01	6	27.6	18.8	23	14.3	23.4	12	16	16.5
	1/4"	PB8-02	9	29.4	18.8	23	14.3	26.7	17	16	22.5
	3/8"	PB8-03	9	30.1	18.8	23	14.3	27.4	17	16	27
φ 10	1/8"	PB10-01	6	31.6	19.7	26.8	17.8	53.6	17	16	32
	1/4"	PB10-02	9	33.4	19.7	26.8	17.8	53.6	17	30	34
	3/8"	PB10-03	9	34.1	19.7	26.8	17.8	53.6	17	30	35
	1/2"	PB10-04	11	36.1	19.7	26.8	17.8	53.6	21	30	50
φ 12	3/8"	PB12-03	9	36.9	22.3	29.6	20.8	59.2	17	50	51
	1/2"	PB12-04	11	38.9	22.3	29.6	20.8	59.2	21	50	63

L 型二通接头, Y 型二通接头

Fitting

PD 系列

L 型二通接头

PD Series

L male run tee connector

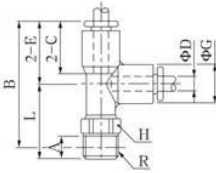

规格 Specification

管径 Bore Φ D	牙径 Port R	型式 Model	A	B	C	E	Φ G	L	对边 Subtense H	有效断面积 Valid acreage mm ²	重量 Weight (g)
φ 4	M5	PD4-M5	3.6	32	14.6	17.5	10.5	16.4	10	3.5	8
	1/8"	PD4-01	6	34.6	14.6	17.5	10.5	20.2	10	4.2	12
	1/4"	PD4-02	9	36.3	14.6	17.5	10.5	23.4	14	4.2	18.5
φ 6	M5	PD6-M5	3.6	36.8	17	20.6	12.4	18.9	10	3.5	11.5
	1/8"	PD6-01	6	39.2	17	20.6	12.4	22.7	10	10	13.5
	1/4"	PD6-02	9	42.1	17	20.6	12.4	26	14	10	20.5
φ 8	3/8"	PD6-03	9	42.8	17	20.6	12.4	26.7	17	10	25.5
	1/8"	PD8-01	6	43.7	18.8	23.1	14.3	23.6	12	16	17
	1/4"	PD8-02	9	45.5	18.8	23.1	14.3	26.9	14	16	23
φ 10	3/8"	PD8-03	9	46.2	18.8	23.1	14.3	27.6	17	16	28
	1/8"	PD10-01	6	49.5	19.7	26.8	17.8	25.7	17	16	32
	1/4"	PD10-02	9	51.3	19.7	26.8	17.8	29	17	30	34
φ 12	3/8"	PD10-03	9	52	19.7	26.8	17.8	29.7	17	30	35
	1/2"	PD10-04	11	54	19.7	26.8	17.8	32.7	21	30	52
	3/8"	PD12-03	9	56.1	22.3	29.7	20.8	31	17	50	47
	1/2"	PD12-04	11	58.1	22.3	29.7	20.8	34	21	50	60

PX 系列

Y 型二通接头

PX Series

Male Y connector

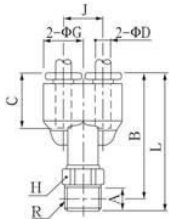

规格 Specification

管径 Bore Φ D	牙径 Port R	型式 Model	A	B	C	Φ G	J	L	对边 Subtense H	有效断面积 Valid acreage mm ²	重量 Weight (g)
φ 4	M5	PX4-M5	3.6	30.4	14.6	10.5	10.5	32.2	10	3.5	8.5
	1/8"	PX4-01	6	33	14.6	10.5	10.5	36	10	4.2	12
	1/4"	PX4-02	9	34.7	14.6	10.5	10.5	39.2	14	4.2	8.5
φ 6	M5	PX6-M5	3.6	34.6	16.9	12.4	12.4	36.4	10	3.5	11.5
	1/8"	PX6-01	6	37.2	16.9	12.4	12.4	40.2	10	10	13.5
	1/4"	PX6-02	9	39	16.9	12.4	12.4	43.5	14	10	20.5
φ 8	3/8"	PX6-03	9	39.7	16.9	12.4	12.4	44.2	17	10	25.5
	1/8"	PX8-01	6	39.7	18.8	14.3	14.3	42.7	12	16	17
	1/4"	PX8-02	6	41.5	18.8	14.3	14.3	46	17	16	23
φ 10	3/8"	PX8-03	9	42.2	18.8	14.3	14.3	46.7	17	16	28
	1/8"	PX10-01	6	42.3	19.7	17.8	17.8	45.3	17	16	32
	1/4"	PX10-02	9	44.1	19.7	17.8	17.8	48.6	17	30	34
φ 12	3/8"	PX10-03	9	44.8	19.7	17.8	17.8	49.3	17	30	35
	1/2"	PX10-04	11	46.8	19.7	17.8	17.8	52.3	21	30	52
	3/8"	PX12-03	9	47.4	22.3	20.8	20.8	51.9	17	50	47
	1/2"	PX12-04	11	49.4	22.3	20.8	20.8	54.9	21	50	60

二通接管, T 型三通接管, Y 型三通接头

Fitting

6

接头系列

Tube connector series

PU 系列 二通接管

PU Series Reducer connector

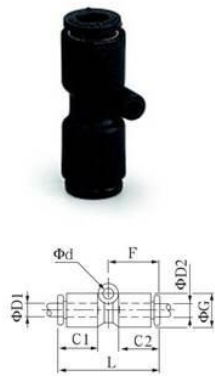

规格 Specification

管径 Bore		型式 Model	C1	C2	Φ d	F	Φ G	L	有效断面积 Valid acreage mm ²	重量 Weight (g)
Φ D1	Φ D2									
Φ 4	Φ 4	PU4	15	15	3.2	16	10.5	31.9	4.2	4
Φ 6	Φ 4	PU6-4	17	15.6	3.2	18	12.4	36	4.2	6
	Φ 6	PU6	17	17	3.2	18	12.4	36	10	6
Φ 8	Φ 6	PU8-6	18.8	17	3.2	21.1	14.3	42.2	10	8
	Φ 8	PU8	18.8	18.8	3.2	21.1	14.3	42.2	16	8
Φ 10	Φ 8	PU10-8	19.7	18.8	4.2	21.8	17.8	43.6	16	16
	Φ 10	PU10	19.7	19.7	4.2	21.8	17.8	43.6	30	16
Φ 12	Φ 10	PU12-10	22.3	19.7	4.2	24.6	20.8	49.1	30	22
	Φ 12	PU12	22.3	22.3	4.2	24.6	20.8	49.1	30	22

PE 系列 T 型三通接管

PE Series T union tee

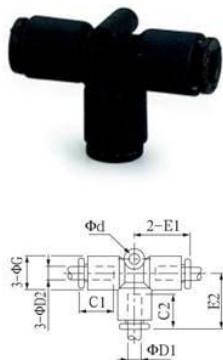

规格 Specification

管径 Bore		型式 Model	C1	C2	Φ d	E1	E2	Φ G	有效断面积 Valid acreage mm ²	重量 Weight (g)
Φ D1	Φ D2									
Φ 4	Φ 4	PE4	15	15	3.2	17.5	17.5	10.5	3.5	6.5
Φ 6	Φ 4	PE6-4	17	15.6	3.2	20.6	15.6	12.4	4.2	8.5
	Φ 6	PE6	17	17	3.2	20.6	20.6	12.4	10	9
Φ 8	Φ 6	PE8-6	18.8	17	3.2	23.6	17.5	14.3	10	12
	Φ 8	PE8	18.8	18.8	3.2	23.6	23.6	14.3	16	12
Φ 10	Φ 8	PE10-8	19.7	18.8	4.2	25.1	25.1	17.8	16	22
	Φ 10	PE10	19.7	19.7	4.2	25.1	25.1	17.8	30	22
Φ 12	Φ 10	PE12-10	22.3	19.7	4.2	29.1	29.1	20.8	30	36
	Φ 12	PE12	22.3	22.3	4.2	29.1	29.1	20.8	30	36

PY 系列 Y 型三通接头

PY Series Y union



规格 Specification

管径 Bore		型式 Model	B	C1	C2	Φ d	Φ G	J	Φ P1	有效断面积 Valid acreage mm ²	重量 Weight (g)
Φ D1	Φ D2										
Φ 4	Φ 4	PY4	37.7	14.6	14.6	3.2	10.5	10.5	12.4	4.2	6.5
	Φ 6	PY6-4	37.8	14.6	17	3.2	10.5	10.5	12.4	4.2	8.5
Φ 6	Φ 4	PY6	40.8	17	17.5	3.2	12.4	12.4	14.3	10	9
	Φ 6	PY8-6	41	17	18.8	3.2	12.4	12.4	14.3	10	12
Φ 8	Φ 6	PY8	44.8	18.8	18.8	3.2	14.3	14.3	17.8	16	12
	Φ 8	PY10-8	45.3	18.8	20.2	3.2	14.3	14.3	17.8	16	22
Φ 8	Φ 6	PY10	50.8	20.2	20.2	4.2	17.8	17.8	21.2	30	22
	Φ 8	PY12-10	50.9	20.2	22.8	4.2	17.8	17.8	21.2	30	36

四通接管, 五通接管, L型回转接头 Fitting

PZA 系列 四通接管
PZA Series Union cross

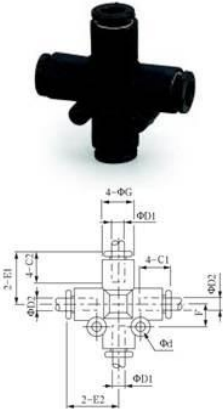

规格 Specification

管径 Bore		型式 Model	C1	C2	φ d	E1	E2	F	φ G	有效断面积 Valid acreage mm ²	重量 Weight (g)
φ D1	φ D2										
φ 4	φ 4	PZA4	14.6	14.6	3.2	17.5	17.5	7.3	10.5	4.2	8.5
φ 6	φ 4	PZA6-4	17	14.6	3.2	20.6	20.6	8.2	12.4	4.2	11.5
	φ 6	PZA6	17	17	3.2	20.6	20.6	8.2	12.4	10	12.5
φ 8	φ 6	PZA8-6	18.8	17	3.2	23.6	23.4	9.2	14.3	10	18
	φ 8	PZA8	18.8	18.8	3.2	23.6	23.6	9.2	14.3	16	16
φ 10	φ 8	PZA10-8	19.7	18.8	4.2	25.1	25.1	10.8	17.8	16	32
	φ 10	PZA10	19.7	19.7	4.2	25.1	25.1	10.8	17.8	30	30
φ 12	φ 10	PZA12-10	22.3	19.7	4.2	29.1	29.1	12.1	20.8	30	47
	φ 12	PZA12	22.3	22.3	4.2	29.1	29.1	12.1	20.8	50	45

PK 系列 五通接管
PK Series Triple branch

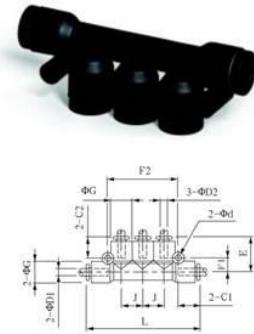

规格 Specification

管径 Bore		型式 Model	C1	C2	φ d	E	F1	F2	L	φ G	J	有效断面积 Valid acreage mm ²	重量 Weight (g)
φ D1	φ D2												
φ 4	φ 4	PK4	14.6	14.6	3.2	20.6	7.8	40.4	66	12.4	12.4	4.2	16
φ 6	φ 4	PK6-4	17	14.6	3.2	20.6	7.8	40.4	66	12.4	12.4	4.2	16
	φ 6	PK6	17	17	3.2	20.6	7.8	40.4	66	12.4	12.4	10	16.5
φ 8	φ 6	PK8-6	18.8	17	3.2	22.9	8.8	46.2	76.4	14.3	14.3	10	26
	φ 8	PK8	18.8	18.8	3.2	23.1	8.8	46.2	76.4	14.3	14.3	16	22
φ 10	φ 8	PK10-8	19.7	18.8	4.2	25.9	10.8	57.1	85.7	17.8	17.8	16	31
	φ 10	PK10	19.7	19.7	4.2	25.9	10.8	57.1	85.7	17.8	17.8	30	33
φ 12	φ 10	PK12-10	22.3	19.7	4.2	29.1	12.1	65.8	99.7	20.8	20.8	30	
	φ 12	PK12	22.3	22.3	4.2	29.1	12.1	65.8	99.7	20.8	20.8	50	

PH 系列 L型回转接头
PH Series Male banjo connector

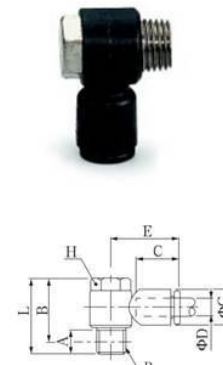

规格 Specification

管径 Bore φ D	牙径 Port R	型式 Model	A	B	C	E	φ G	L	对边 Subtense H	有效断面积 Valid acreage mm ²	重量 Weight (g)
φ 4	M5	PH4-M5	4	17	15	21.5	10.5	19.5	8	4	6.5
	1/8"	PH4-01	7.5	20.8	19	25.5		23.8	10	5.5	16
φ 6	M5	PH6-M5	4	17	15	21.5	12.4	19.5	8	4	8
	1/8"	PH6-01	7.5	20.8	19	25.5		23.8	10	5.5	16
	1/4"	PH6-02	10	23.5	21	29		27.5	14	12.5	36
φ 8	1/4"	PH8-02	10	23.5	21	29	14.3	27.5	14	12.5	45
	3/8"	PH8-03	11	29	24	34		34	19	20	50
φ 10	1/4"	PH10-02	10	23.5	21	29	18	27.5	14	12.5	
	3/8"	PH10-03	11	29	24	34		34	19	20	
φ 12	3/8"	PH12-03	11	29	24	34	21.5	34	19	20	
	1/2"	PH12-04	15	35.5	25	37		40	24	35	

JSC 系列调速接头(新型式)

Fitting

6

接头系列

Tube connector series



规格 Specification

管径 Port size	Φ4, Φ6, Φ8, Φ10, Φ12				
使用流体 Useing fluid	空气 Air				
使用压力范围 Working pressure range	0 ~ 9(900)Kgf/cm ²				
保证耐压力 Assuring proof pressure	0 ~ 10(1000)Kgf/cm ²				
保证真空压力 Assuring vacuum pressure	-100Kpa(10 Torr)				
螺悍回转数 Revolving nut	10(8)转 Revolution				
使用温度范围 Working temperature range	-5 ~ 60℃				
材料 Material	主体 Connector body	黄铜(镀镍) Brass(nickel-plate)			
	塑胶 Plastic	NLOY, PBT, PP			
连接口径 Rc(PT) Connect port	M5 × 0.8p	1/8"	1/4"	3/8"	1/2"
牙部涂胶 Tooth gelatinize	附涂胶 Attach gelatinize				

制作规格 Specification

型号 Model	管径 Bore	牙径 Port				
		M5	1/8"	1/4"	3/8"	1/2"
JSC4-□	φ 4	●	●	●		
JSC6-□	φ 6	●	●	●	●	
JSC8-□	φ 8		●	●	●	
JSC10-□	φ 10			●	●	●
JSC12-□	φ 12				●	●

订购码 Ordering code

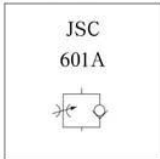
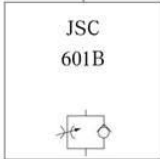
JSC	6	-	01	-	A
型号 Model	管径 Bore		牙径 Port		控制方向 Control direction
	4-φ4mm 6-φ6mm 8-φ8mm 10-φ10mm 12-φ12mm		M5-M5 01-R1/8 02-R1/4 03-R3/8 04-R1/2		
JSC: 调速接头 JSC: Speed controllers					A: 排气节流控制 (标准型式) A: Exhaust throttle control(standard type)
					
					B: 准气节流控制 (特殊型式) B: Normal throttle control(special type)

JSC 系列调速接头(新型式)

Fitting

内部结构图 ○

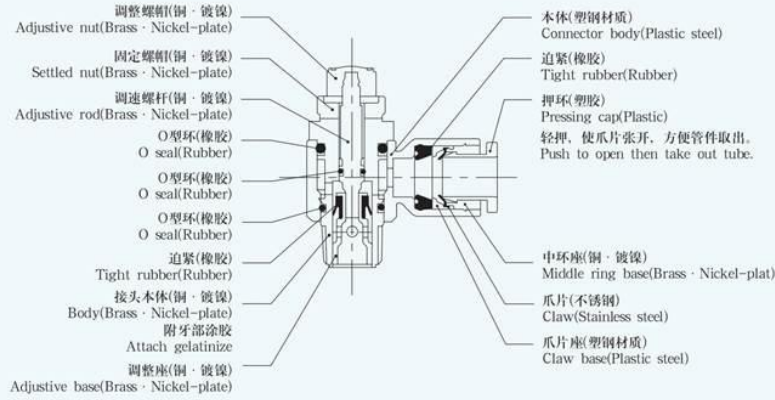

外形尺寸 Dimension

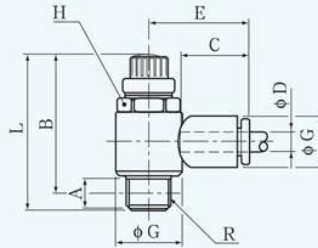

管径 Bore ϕD	牙径 Port R	型式 Model	A	B		C	E	L		ϕG_1	ϕG_2	对边 Subtense H	有效断面积 Valid acreage mm ²	重量 Weight (g)
				最大 Max	最小 Min			最大 Max	最小 Min					
$\phi 4$	M5	JSC4-M5	4	24.9	22.4	15	21.5	28.5	26	10.5	10	8	4	10
	1/8"	JSC4-01	7.5	35	29	19	25.5	38	32		14.2	10	5.5	20
	1/4"	JSC4-02	10	38	31.5	21	29	42.5	36		18.6	14	12.5	34
$\phi 6$	M5	JSC6-M5	4	24.9	22.4	15	21.5	28.5	26	12.4	10	8	4	10
	1/8"	JSC6-01	7.5	35	29	19	25.5	38	32		14.2	10	5.5	20
	1/4"	JSC6-02	10	38	31.5	21	29	42.5	36		18.6	14	12.5	36
	3/8"	JSC6-03	11	44.5	37.5	24	34	49	42		23	19	20	60
$\phi 8$	1/8"	JSC8-01	7.	35	29	19	25.5	38	32	14.3	14.2	10	2.5	20
	1/4"	JSC8-02	10	38	31.5	21	29	42.5	36		18.6	14	12.5	36
	3/8"	JSC8-03	11	44.5	37.5	24	34	49	42		23	19	20	60
$\phi 10$	1/4"	JSC10-02	10	38	31.5	21	29	42.5	32	18	18.6	14	12.5	40
	3/8"	JSC10-03	11	44.5	37.5	24	34	49	42		23	19	20	64
	1/2"	JSC10-04	15	52	44.5	25	37	57.5	50		28	24	35	98
$\phi 12$	3/8"	JSC12-03	11	44.5	37.5	24	34	49	42	21.5	23	19	20	68
	1/2"	JSC12-04	15	52	44.5	25	37	57.5	50		28	24	35	102

PA 系列调速接头(新型式)

Fitting

6

接头系列

Tube connector series



规格 Specification

管径 Port size	Φ4, Φ6, Φ8, Φ10, Φ12	
使用流体 Useing fluid	空气 Air	
使用压力范围 Working pressure range	0 ~ 9(900)Kgf/cm ²	
保证耐压力 Assuring proof pressure	0 ~ 10(1000)Kgf/cm ²	
保证真空压力 Assuring vacuum pressure	-100Kpa(10 Torr)	
螺悍回转数 Revolving nut	10(8)转 Revolution	
使用温度范围 Working temperature range	-5 ~ 60℃	
材料 Material	主体 Connector body	黄铜(镀镍) Brass(nickel-plate)
	塑胶 Plastic	NYLOY, PBT, PP

制作规格 Specification

型号 Model	管径 Bore
PA4	φ 4
PA6	φ 6
PA8	φ 8
PA10	φ 10
PA12	φ 12

订购码 Ordering code

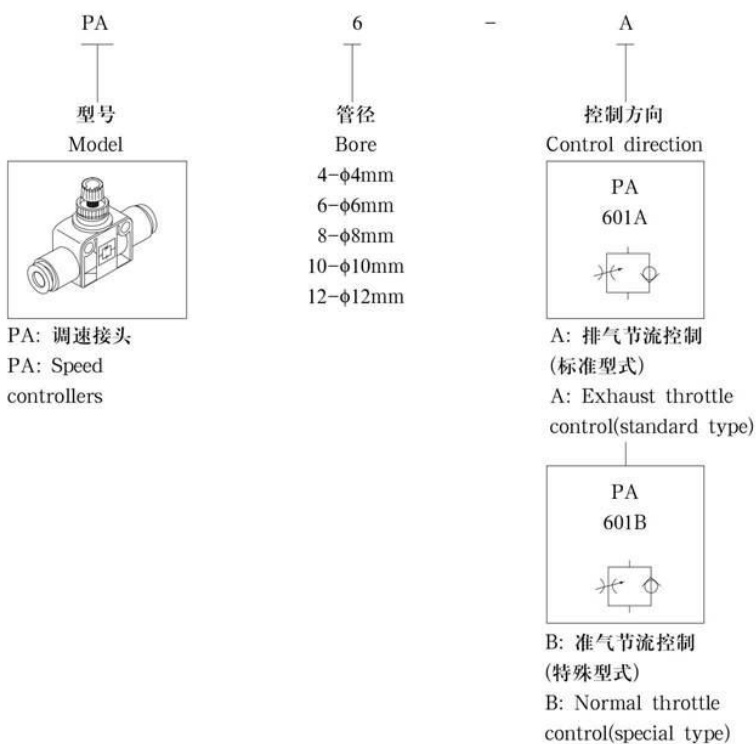

PA 系列调速接头(新型式)

Fitting

内部结构图 Diagram of internal structure

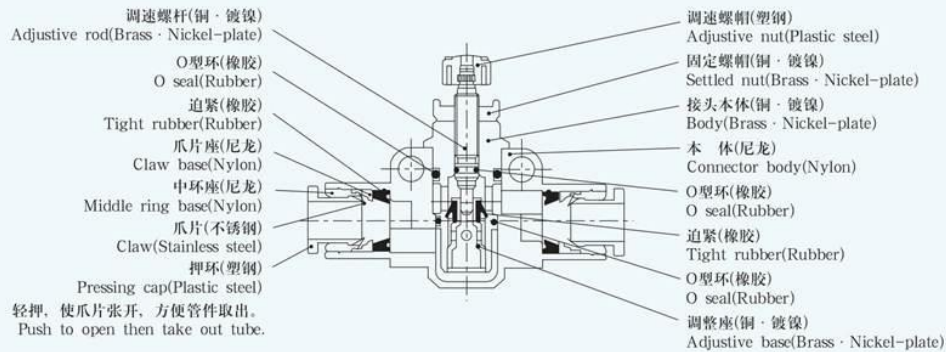

外形尺寸 Dimension

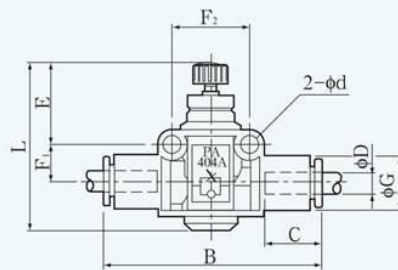

管径 Bore ϕD	型式 Model	B	C	ϕd	E	F_1	F_2	L		ϕG	有效断面积 Valid acreage mm ²	重量 Weight (g)
								最大 Max	最小 Min			
$\phi 4$	PA4	41	14.6	3.2	13.1	6.9	14	29.8	27.4	10.5	5.5	12
$\phi 6$	PA6	49	16.5	4.3	18.1	8.6	18	41.9	37.7	12.8	12	26
$\phi 8$	PA8	54.9	17.8	4.3	19.6	9.6	22	47.6	40.3	14.5	16	42
$\phi 10$	PA10	63.1	19.7	4.3	21.9	10.7	25.6	50.7	45.3	18.3	20	
$\phi 12$	PA12	72.9	22.3	4.3	23.8	11.9	32	56.2	49	21.3	35	

PSL 系列塑料消声器
PSL Series plastic
sliencer



型号 Model

AN200-02
AN300-03
AN400-04

PST 系列铜消声器
PST Series brass
sliencer



型号 Model

PST-M5
PST-01
PST-02
PST-03
PST-04
PST-06
PST-10

PSV 系列铜消声器
PSV Series brass
sliencer



型号 Model

PSV-01
PSV-02
PSV-03
PSV-04
PSV-06
PSV-10

切管器
PU-cutter



TS-L 系列气枪
TS-L Series airguns
Length:360mm



TSA 系列气枪
TSA Series airguns
length:217mm



PU 管
Pu pipe

型号 Model

PU6 × 4-3
PU8 × 5-3
PU10 × 6.5-3
PU12 × 8-3





JIANGXI YIKAI ELECTRIC CO., LTD.

Add: No.31,JiaHai Industrial Park,High-Tech
Development Zone,Nanchang,Jiangxi,China

Tel:86-0791-88383977

Fax:86-0791-88383677

Email:blesia@cnecan.com

Http://www.cnecan.com